

PRODUCT CATALOGUE

VOLGABUS
GROUP

VOLGABUS
GROUP

Volgabus group

Volgabus Holding was founded by transport specialists - those who have been operating buses for many years, putting hundreds of cars on the route every day.

That is the reason why while creating new models, we try to make them as economical and simple in service as possible for carriers. Comfortable for drivers. Comfortable and friendly for passengers.

Volgabus invests in engineering solutions to effectively address mobility issues in cities and beyond.

We understand that having passed you the Volgabus buses, we become a part of your team and together with you are responsible for the smooth operation of the vehicles. Therefore, the specialists of our holding are doing everything so that you can count on our support in any region of Russia.

Our model range offers a variety of configurations, a large selection of components and additional equipment. This catalogue introduces city, suburban, intercity and electric buses of Volgabus.

Alexey Bakulin
CEO «Volgabus Group»



Contents

CityRhythm 10 Family
p.06



CityRhythm 12 Family
p.16



Electrobus
CityRhythm 12E
p.28



CityRhythm 18
p.36

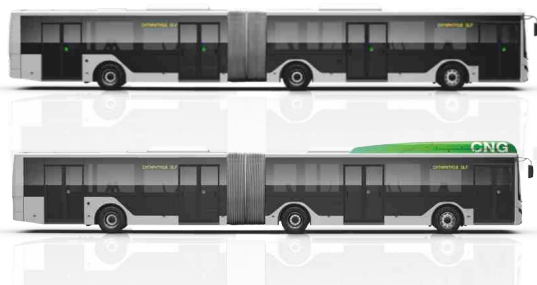

Serpentine
p. 44



Marathon
p. 50



Delta
p.56





Volgabus group was founded in 1993 and in just a few years has become an acknowledged innovative leader of the Russian bus industry.

70% of new products on the domestic bus market have been designed at our R&D centers. Our buses operate on routes in more than 100 cities of Russia.

Today leading manufacturers trust our extensive expertise. Volgabus group is constantly increasing its export potential and is in cooperation with global leading producers.

The group has 2 research and production complexes: in the Volgograd and Vladimir regions. The total production capacity allows the production of up to 3000 buses per year. The company employs over 1,500 employees.

Flexible production lines equipped with robotic welding and metalworking complexes allow to fulfill large orders within the shortest possible period.



CityRhythm

City Bus Family

The city is always on the move.
In search of its hero. Strong. Reliable. Ready for any turn.
The Cityrhythm family of city buses was created to provide urban mobility 24/7, taking care of your calm, ecology and passenger comfort.

Many options for the aggregate base with a diesel or gas engine make it possible to choose a bus with a length of 10, 12 or 18 meters according to your city needs.









CityRhythm 10

10 meter city buses

GLE

gas

passenger capacity

53-65

seating capacity

27-29

doors

2



DLE

diesel

passenger capacity

53-65

seating capacity

27-29

doors

2



compact + roomy

the ideal solution

for small cities or routes

with low passenger traffic

CityRhythm 10 - a bus that will give you more than it might seem at first glance.

EconomiCical engines and high capacity with compact dimensions make the 10-meter vehicles of the Cityritm series an ideal solution for small and medium cities.

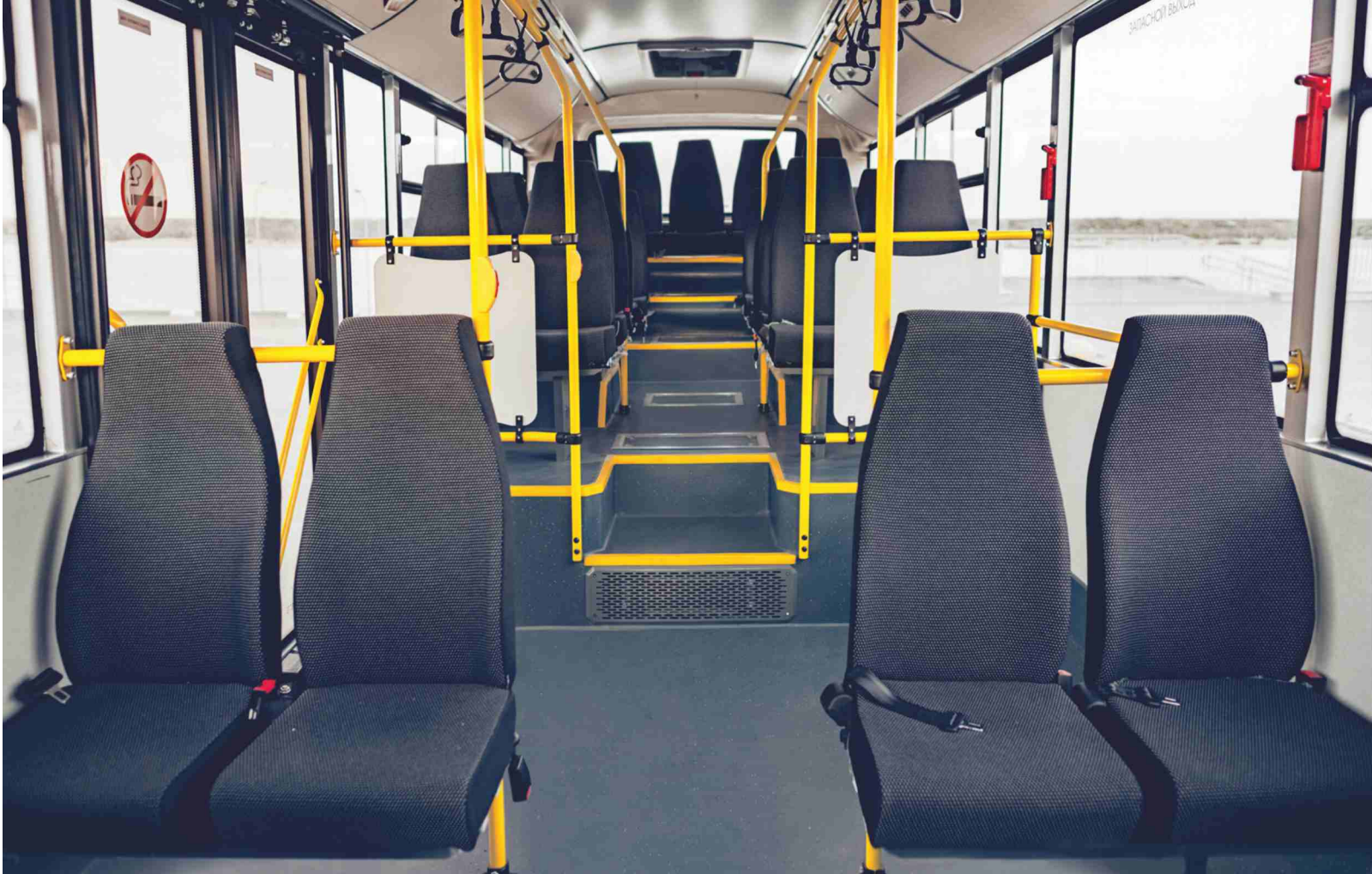



CityRhythm 10 Low Floor bus interior

CityRhythm 10

EURO-5

LOW ENTRY

Modifications

GLE

DLE

Factory id	VOLGABUS 5270GH-0000010	VOLGABUS 5270OH-0000010
Engine	YUCHAI YC6J210N-52 Стандарт Евро-5	YUCHAI YC6J220-50 Стандарт Евро-5
Output, kWt	146	153
Gear box	Automatic, manual	Manual
Gas equipment	Metal composite gas cylinders, type 3, 123 l × 6 pcs.	
Cruising range, km	350	

Interior layout

[BASIC]

City Suburban

27

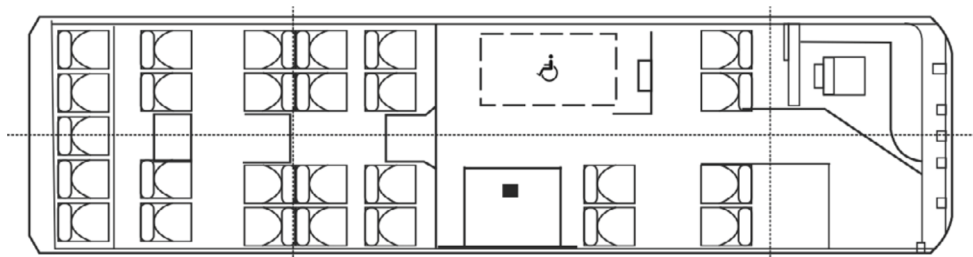

Specifications

Body	one-story, closed, all-metal, monocoque, carriage layout	Front axle	FANGSHENG	Steering	Hydraulic
		Drive axle	FANGSHENG	Brake system	Pneumatic, dual circuit with ABS Suburban option DLE: Pneumatic, dual circuit with ABS, EBS, ESC, ASR
Wheel base	4 × 2	Front suspension	Dependent, pneumatic or pneumatic with control system (ECAS), with “kneeling” function on the right side. 2 hydraulic telescopic shock absorbers, 1 body position adjuster, anti-roll bar.	Climate system	Diesel liquid heater, air conditioning (option)
Dimensions, mm	L 10080 × W 2500 × H 2870–2900 H 3050 optional height with air conditioning	Back Suspension	Dependent, pneumatic or pneumatic with control system (ECAS), with “kneeling” function to the right side. 4 hydraulic telescopic shock absorbers, 2 body position	Tyres	Tubeless 255/70 R22.5 or 275/70 R22.5
Unladen weight, kg	10 550				
Total weight, kg	15 000				

City Suburban

35

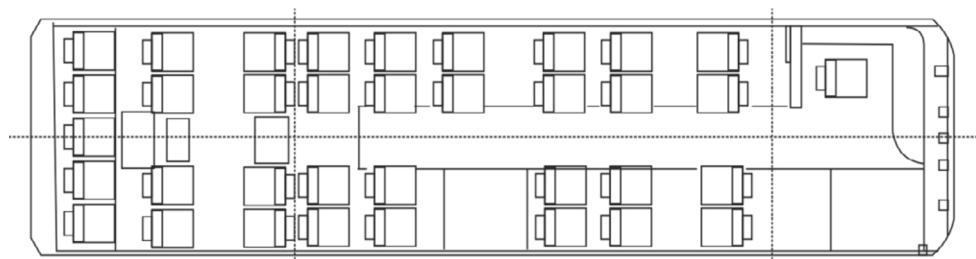





CityRhythm 12

12 meter gas city buses

GLE

gas low entry

Passenger
capacity

111

Seating
capacity

29

Doors

3



GLF

gas low floor

Passenger
capacity

111

Seating
capacity

28

Doors

3





comfort + efficiency

What can a modern bus offer to a city?

Impressive environmental performance with the latest generation of gas engines.

High economic performance for effective operation.

And of course, a pleasant feeling from a ride in a comfortable and bright interior.



CityRhythm 12 GLF Low Floor bus interior



CityRhythm 12 GLE Low entry bus interior

CityRhythm 12

EURO-5

Low entry and low floor gas engine buses

Modifications

GLE / GLF

Factory id

VOLGABUS
5270G2-0000010

Engine

YUCHAI YC6L280N-52
Стандарт Евро-5

Output, kWt

206

Gear box

Automatic

Gas equipment

Metal composite gas cylinders
type 3, 123 l × 8 pcs

Cruising range, km

400

Interior layout [BASIC]

Low entry GLE

29

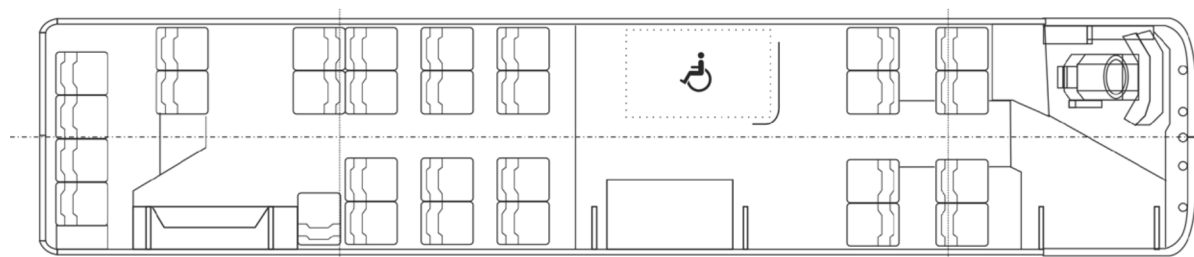

Specifications

Body	one-story, closed, all-metal, monocoque, carriage layout
Wheel base	4 x 2
Dimensions, mmL	11990 x W 2500 x H 3250
Unladen weight, kg	10 400
Total weight, kg	18 000

GLE

Front axle	ZF, RABA I DDAC[DANA]
Drive axle	RABA, DDAC [DANA]

GLF

Front axle	ZF, RABA, GK [OERLIKON]
Drive axle	ZF, GK [OERLIKON]
Front suspension	Dependent, pneumatic or pneumatic with control system (ECAS), with "Kneeling" function on the right side. 2 hydraulic telescopic shock absorbers, 1 body position adjuster, anti-roll bar.

Back Suspension	Dependent, pneumatic or pneumatic with control system (ECAS), with "kneeling" function to the right side. 4 hydraulic telescopic shock absorbers, 2 body position adjusters.
-----------------	---

Steering	Hydraulic
Brake system	Pneumatic double-circuit with ABS, ASR

Climate system	Liquid heater, optional air conditioning gas pre-launch heater
----------------	---

Tyres	Tubeless 275/70 R22,5
-------	------------------------------

Low Floor DLF

28

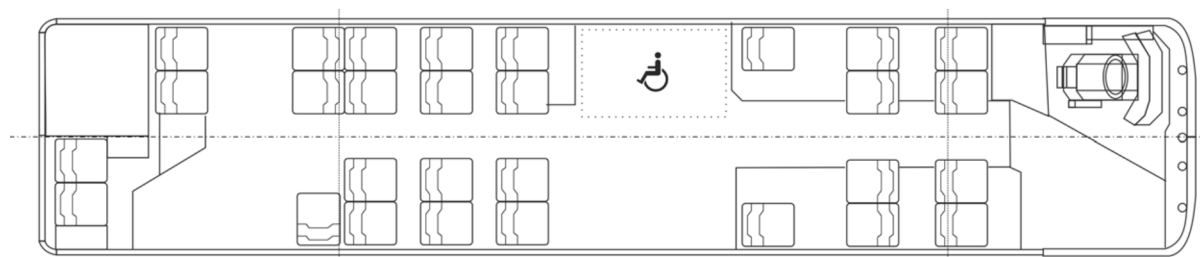





CityRhythm 12

12 meter diesel city buses

DLE

Diesel low entry
Passenger
capacity
seating capacity
doors

Passenger
capacity

111

Seating
capacity

29

Doors

3



DLF

Diesel low entry
Passenger
capacity
seating capacity
doors

Passenger
capacity

11

Seating
capacity

28

Doors

3

CityRhythm 12

EURO-5

Low entry
and low floor diesel
engine buses

Modifications

DLE / DLF

DLF

Factory id

VOLGABUS
527002-0000010

VOLGABUS
5270-0000010

Engine

YUCHAI YC6L310-50
Стандарт Евро-5

MAN DO836LOH64
Стандарт Евро-5

Output, kWt

218

213

Gear box

Automatic

Automatic

Interior layout
[BASIC]

Low entry DLE

29

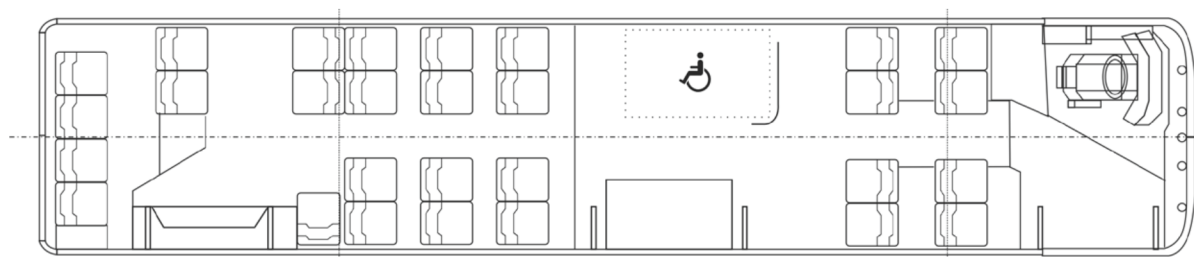

Specifications

Body	one-story, closed, all-metal, monocoque, carriage layout	DLE	Front axle	ZF, RABA I DDAC [DANA]	Back	
			Drive axle	RABA, DDAC [DANA]	Suspension	Dependent, pneumatic or pneumatic with control system (ECAS), with “kneeling” function to the right side. 4 hydraulic telescopic shock absorbers, 2 body position adjusters.
Wheel base	4 x 2					
		DLF				
Dimensions, mmL	11990 x W 2500 x H 2900		Front axle	ZF, RABA, GK [OERLIKON]	Steering	Hydraulic
Unladen weight, kg	10 000		Drive axle	ZF, GK [OERLIKON]	Brake system	Pneumatic double-circuit with ABS, ASR
Total weight, kg	18 000		Front suspension	Front suspension Dependent, pneumatic or pneumatic with control system (ECAS), with “Kneeling” function on the right side. 2 hydraulic telescopic shock absorbers, 1 body position adjuster, anti-roll bar.	Climate system	Diesel liquid heater, optional air conditioning
					Tyres	Tubeless 275/70 R22,5

Low Floor DLF

28

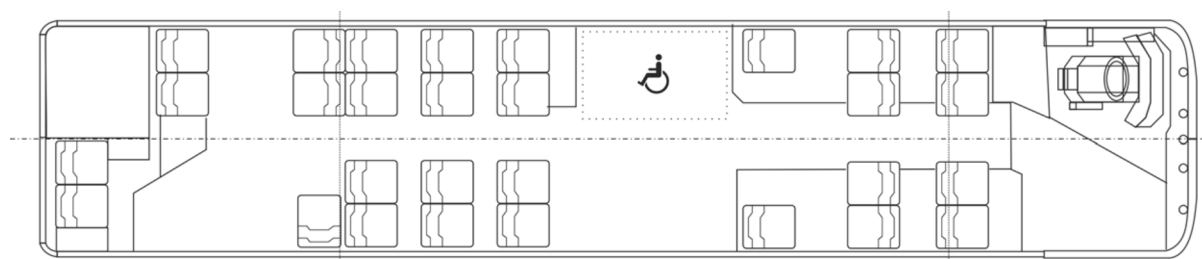



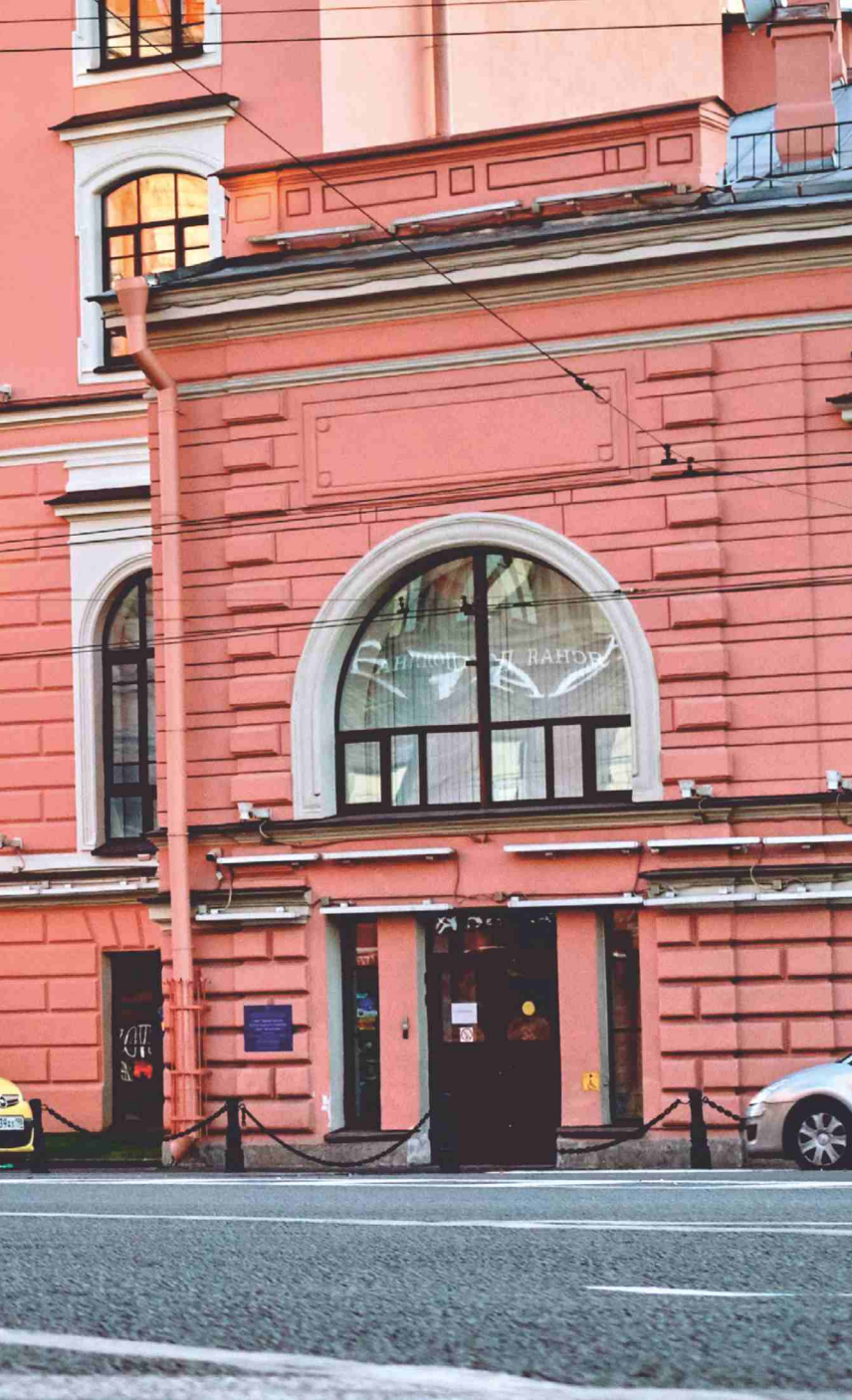

CityRhythm 12 E

Lowfloor electrobuses

E

ELECTROBUS



Passenger
capacity

75-90



Seating
capacity

27-32



Doors

3

E-time has come!

**+ High Capacity LFP Batteries
up to 432 Ah**

+ Driving range up to 300 km

due to energy saving
technologies





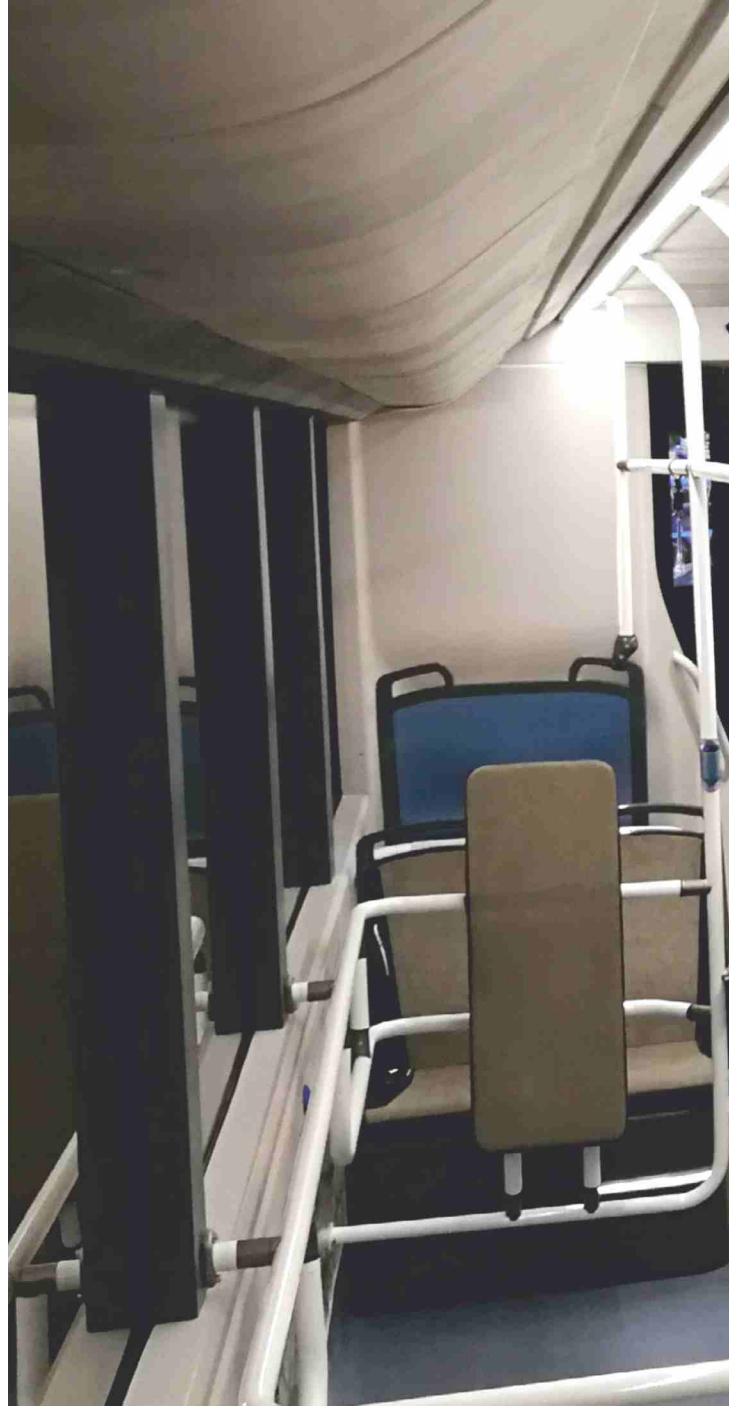



CityRhythm 12 E

Lowfloor electrobuses

Factory id	VOLGABUS 5270E
Electric Engine	KPA-200M4H
Output, kWt	115
Battery Cell Type	LFP
Charging time	5 hrs
Driving range, km	200 with payload and switch-on climate control system 300 in running order with switch-off climate control system

Interior layout [BASIC]

27

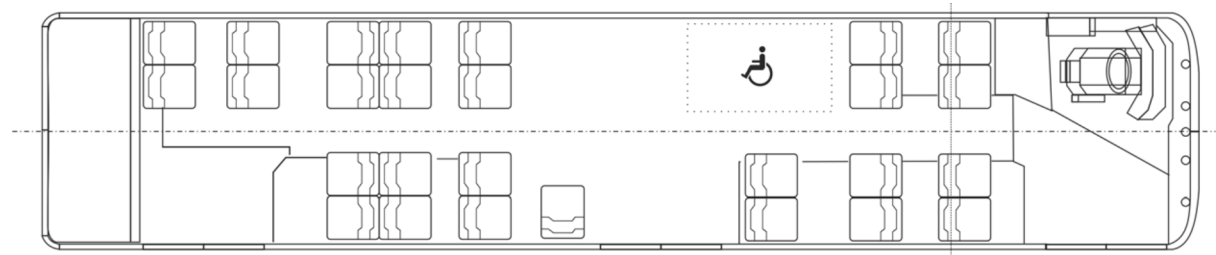

Specifications

Body	one-story, closed, all-metal, monocoque, carriage layout	Steering	Electric
Wheel base	4 x 2	Braking distance at 60 km/h with full load, m	no more than 36.7 with the working brake system; no more than 64.4 with the spare brake system
Dimensions, mmL	11990 x W 2500 x H 3250 with air conditioner	Tyres Tubeless	275/70 R22,5
Unladen weight, kg	12 900		
Total weight, kg	18 000 19 000		

- **Battery life cycle up to 10 years**
- **Fast night charge (4 - 5 hours)**
- **Traction batteries at the rear of the electric bus**
- **Diversity electronic components (cable footage)**
- **Climate control and other options**





CityRhythm 18

Diesel low floor buses
increased capacity

DLF

Diesel lowfloor

Passenger
capacity

170

Seating
capacity

38+3

Doors

4



GLF

Gas lowfloor

Passenger
capacity

184

Seating
capacity

37+1

Doors

4

large + high-powered an ideal bus for megalopolis

Big city needs a big bus.

CityRhythm 18 is able to take aboard up to 170 people and provide high speed of passenger exchange thanks to the body kneeling system, low floor salon, spacious interior and 4 doors with wide openings. Even at rush hour there is enough room for everyone. Besides an interactive systems will provide passengers with the information about route stops, weather, transfer possibilities, etc.





CityRhythm 18

EURO-5

Diesel Low floor
high-capacity buses

Modifications

Factory id	VOLGABUS 6271-0000010	VOLGABUS 627105-0000010
Engine	MAN DO836LOH64 EURO-5	MAN D2066LOH37 EURO-5
Output, kWt	213	235
Gear box	Automatic with retarder	Automatic with retarder

Interior layout
[BASIC]

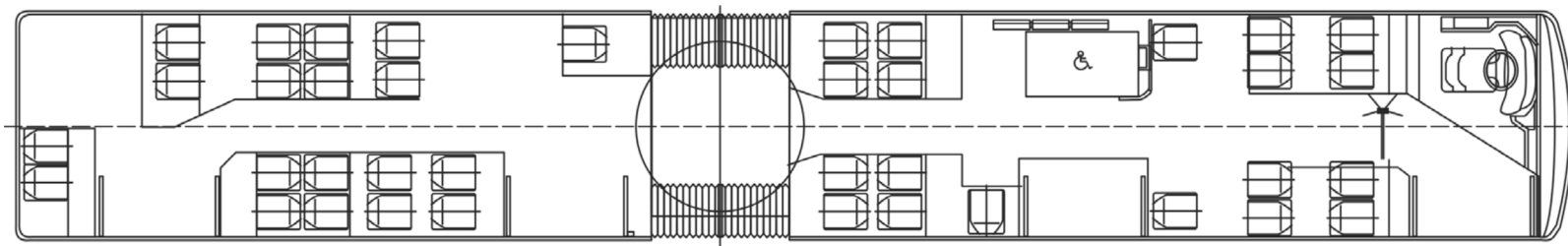

38+3

Specifications

Body	Articulated, one-story, closed, all-metal, carriage layout	Front axle	ZF	Steering	Hydraulic
Wheel base	6 x 2	carrying axle	ZF	Brake system	Pneumatic double-circuit with ABS, ASR
Dimensions, mmL	17990–18190 x W 2500 x H 2900	Drive axle	ZF	Climate system	Diesel liquid heater, optional air conditioning
	H 3050 optional height with air conditioning	Front suspension	Dependent, pneumatic or pneumatic with control system (ECAS), with “Kneeling” function on the right side. 2 hydraulic telescopic shock absorbers, 1 body position adjuster, anti-roll bar.	TyresTubeless	275/70 R22,5
Unladen weight, kg	16 440	Middle suspension	dependent pneumatic, 2 body position adjusters		
Total weight, kg	28 000	Back Suspension	Dependent, pneumatic or pneumatic with control system (ECAS), with “kneeling” function to the right side. 4 hydraulic telescopic shock absorbers, 2 body position adjusters.		

CityRhythm 18

EURO-5

Modifications

Factory id	VOLGABUS 6271-0000010	VOLGABUS 627105-0000010
Engine	MAN D0836LOH64 EURO-5	MAN D2066LOH37 EURO-5
Output, kWt	213	235
Gear box	Automatic with retarder	Automatic with retarder

Interior layout
[BASIC]

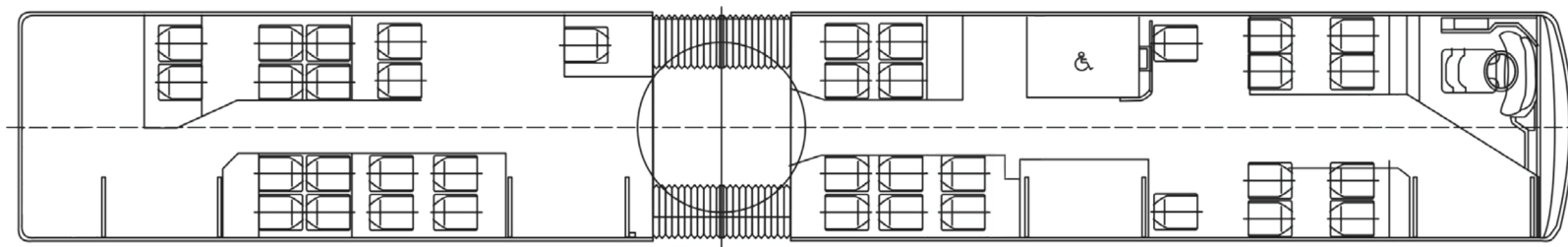

37+1

Specifications

Body	Articulated, one-story, closed, all-metal, carriage layout	Front axle	ZF	Steering	Hydraulic
Wheel base	6 x 2	carrying axle	ZF	Brake system	Pneumatic double-circuit with ABS, ASR
Dimensions, mmL	18500 x W 2500 x H 2900	Drive axle	ZF	Climate system	Diesel liquid heater, optional air conditioning
	H 3250 optional height with air conditioning	Front suspension	Dependent, pneumatic or pneumat with control system (ECAS), with “Kneeling” function on the right side. 2 hydraulic telescopic shock absorbers, 2 body position adjuster, anti-roll bar.	TyresTubeless	275/70 R22,5
Unladen weight, kg	16 440	Middle suspension	Pneumatic with control system (ECAS), with “kneeling” function to the right ide. 4 hydraulic telescopic shock absorbers, 1 body position adjusters.		
Total weight, kg	28 000	Back Suspension	Dependent, pneumatic or pneumatic with control system (ECAS), with “kneeling” function to the right ide. 4 hydraulic telescopic shock absorbers, 2 body position adjusters.		



Serpentine

Intercity gas and diesel buses

G
gas

Seating
capacity
45-47

Doors
2

Baggage capacity, m³
5



D
diesel

Seating
capacity
45-47

Doors
2

Baggage capacity, m³
5

ergonomics + equipment

travel time can be enjoyable

What unites us?

Social networks, messengers, calls? The most pleasant is personal communication. Intercity Serpentine buses bring the long-awaited meeting with friends and family.

Comfortable salon, LED lighting and soft suspension make any road easy.

The equipment options give you the freedom to choose the optimal power pack and equipment.

Intercity gas and diesel buses

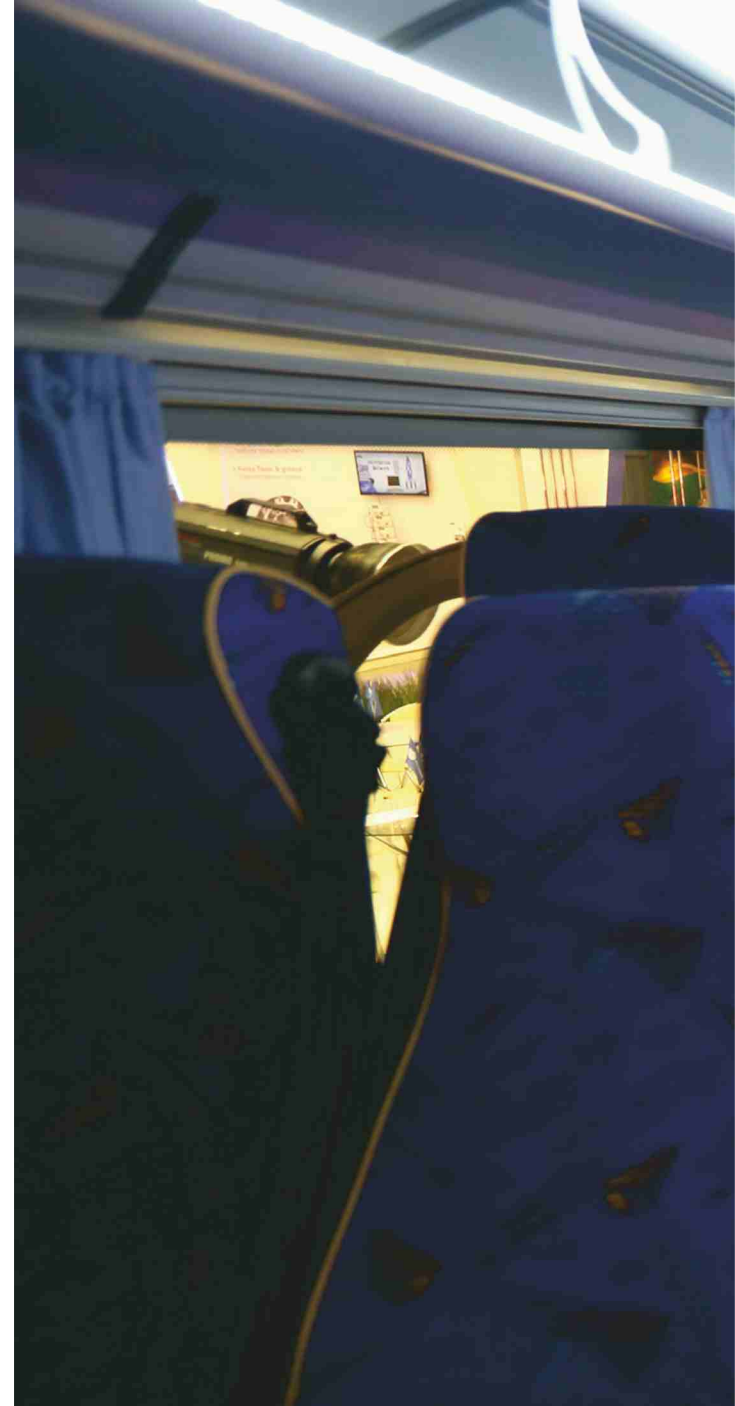



Serpentine

EURO-5

Intercity gas and diesel buses

Modifications

G

D

Factory id

VOLGABUS
5285G2-0000010

VOLGABUS
528502-0000010

Engine

YUCHAI YC6L280N-52
EURO-5

YUCHAI YC6310-50
EURo-5

Output, kWt

197

218

Gear box

Mechanic

Mechanic

Interior layout
[BASIC]

45

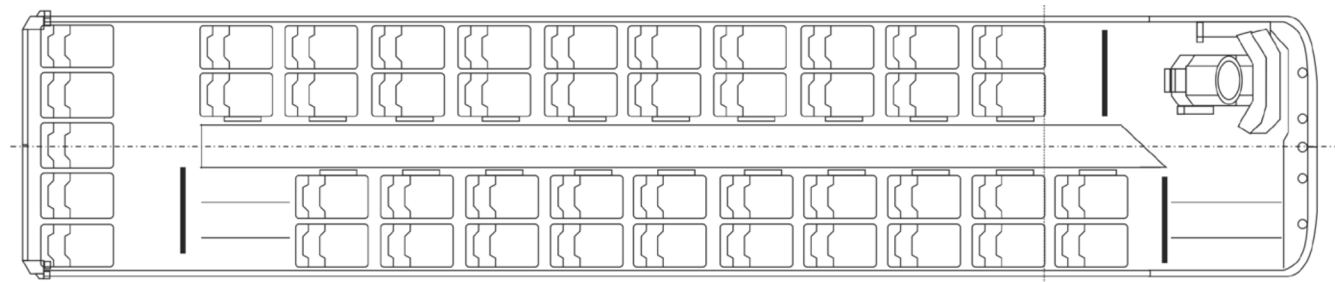

Specifications

Body **One-story, closed, all-metal, monocoque, carriage layout**

Wheel base **4 × 2**

G

Dimensions, mm **L 11990 × W 2500 × H 3250**

Unladen weight, kg **14 010**

Total weight, kg **18 000**

D

Dimensions, mm with AC **L 11990 × W 2500 × H 3050**

Unladen weight, kg **12 650**

Total weight, kg **18 000**

Drive axle **RABA, DDAC [DANA]**

Front axle **ZF, RABA, DDAC [DANA]**

Drive axle **RABA, DDAC [DANA]**

Front

suspension **Dependent, pneumatic or pneumatic with control system (ECAS), with “Kneeling” function on the right side. 2 hydraulic telescopic shock absorbers, 1 body position adjuster, anti-roll bar.**

Back Suspension **Dependent, pneumatic or pneumatic with control system (ECAS), with “kneeling” function to the right side. 4 hydraulic telescopic shock absorbers, 2 body position adjusters.**

Steering **Hydraulic**

Brake system **Pneumatic, dual-circuit or pneumatic with electronic control (EBS)**

Climate system **Diesel liquid heater, optional air conditioning, gas preheater**

Tyres **Tubeless 275/70 R22,5**





Marathon

Medium-distance intercity gas
and diesel buses

G
gas

Seating capacity

47-55

Doors

2

Baggage capacity, m³

6



D
diesel

Seating capacity

47-55

Doors

2

Baggage capacity, m³

6

reliable + comfortable medium-distance intercity bus

Every journey is a discovery.
New meetings, impressions, emotions.
Marathon line was created for many more pleasant moments ahead.
Increased wheelbase allowed to expand the distance between the seats, which makes the trip even more comfortable. Large luggage compartments, chargers for gadgets, multimedia systems and the possibility of installing additional equipment allow to create a bus for every type of transportation.

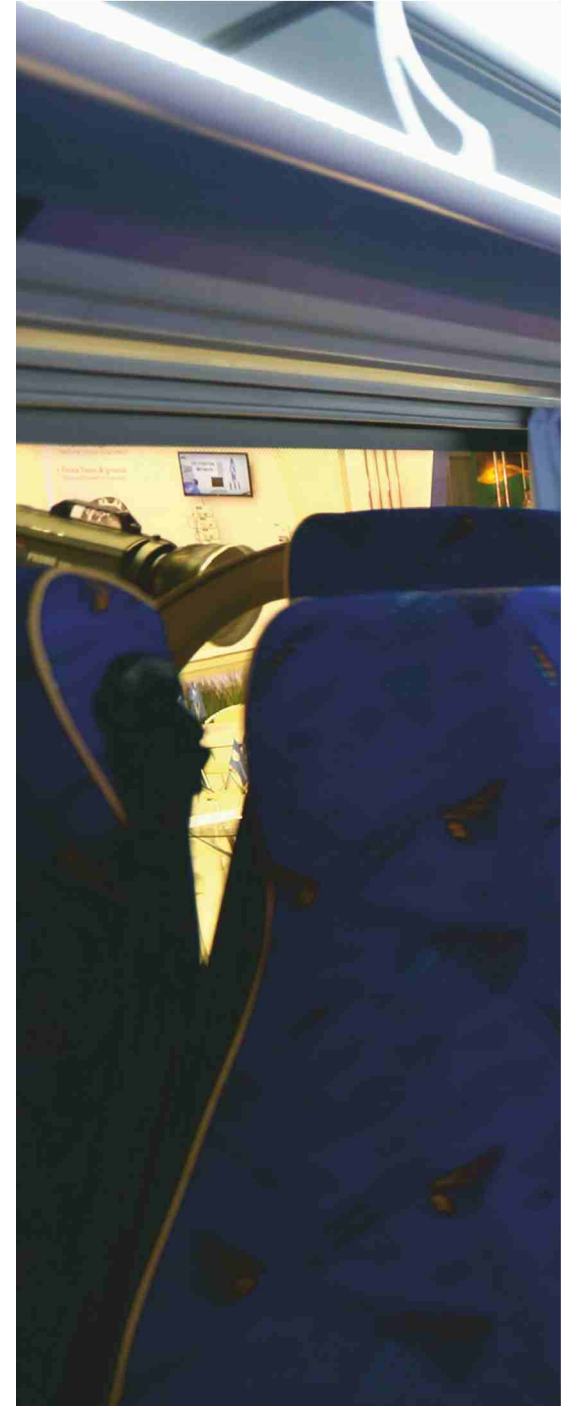



Marathon

EBPO-6

EBPO-5

Medium-distance intercity gas
and diesel buses

Modifications

G

D

Factory id

VOLGABUS
5285G0000010

VOLGABUS
528502

Engine

YUCHAI YCK08300-60
EURO-6

YUCHAI YC6L310-50
EURO-6

Output, kWt

221

218

Gear box

Automatic, Mechanic

Automatic, Mechanic

Interior layout
[BASIC]

47

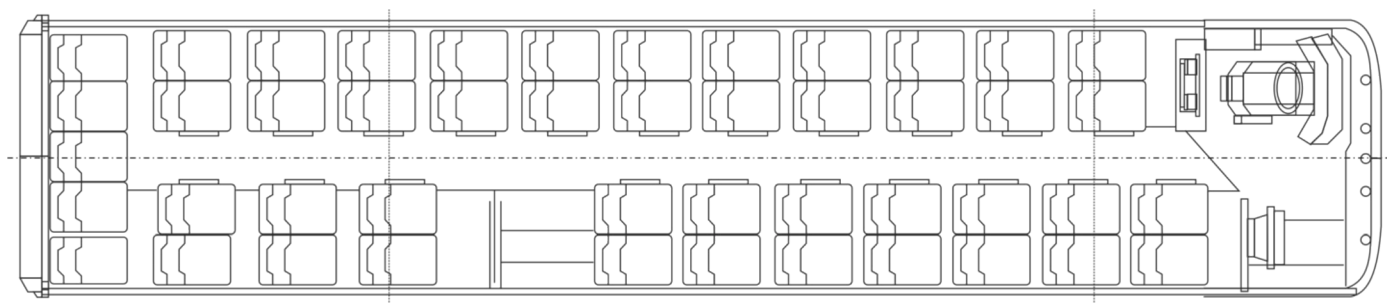

Specifications

Body **One-story, closed, all-metal, monocoque, carriage layout**

Wheel base **4 x 2**

Dimensions, mm **L 12580 × W 2500 × H 3050**

G

Unladen weight, kg **14 000**

D

Unladen weight, kg **13 490**

Total weight, kg **18 000**

Front axle **ZF, RABA, Dana or alternative**

Drive axle **RABA, Dana or alternative**

Front suspension **Dependent, pneumatic.
2 hydraulic telescopic shock absorbers, 1 body position adjuster, anti-roll bar.**

Back Suspension **Dependent, pneumatic.
4 hydraulic telescopic shock absorbers, 2 body position adjusters.**

Optional. pneumatic with control system (ECAS)

Steering **Hydraulic**

Brake system **Pneumatic, dual-circuit or pneumatic with electronic control (EBS)**

Climate system **Diesel liquid heater, optional air conditioning**

Tyres **Tubeless 295/80 R22**





DELTA

Coach for intercity
and international routes

D
diesel



Seating capacity

45-55



Doors

2



Baggage capacity, m³

10

friendly+ Splendid

Great journey is always expected with excitement.

Our coach Delta immediately sets for a pleasant road. A comfortable bus with superior comfort armchairs, wide glazing, powerful climate system, mini-kitchen, modern multimedia center and huge luggage compartments invites you for a fascinating trip.

A wide range of options makes it possible to order a bus that will have everything for a trip to any distance.

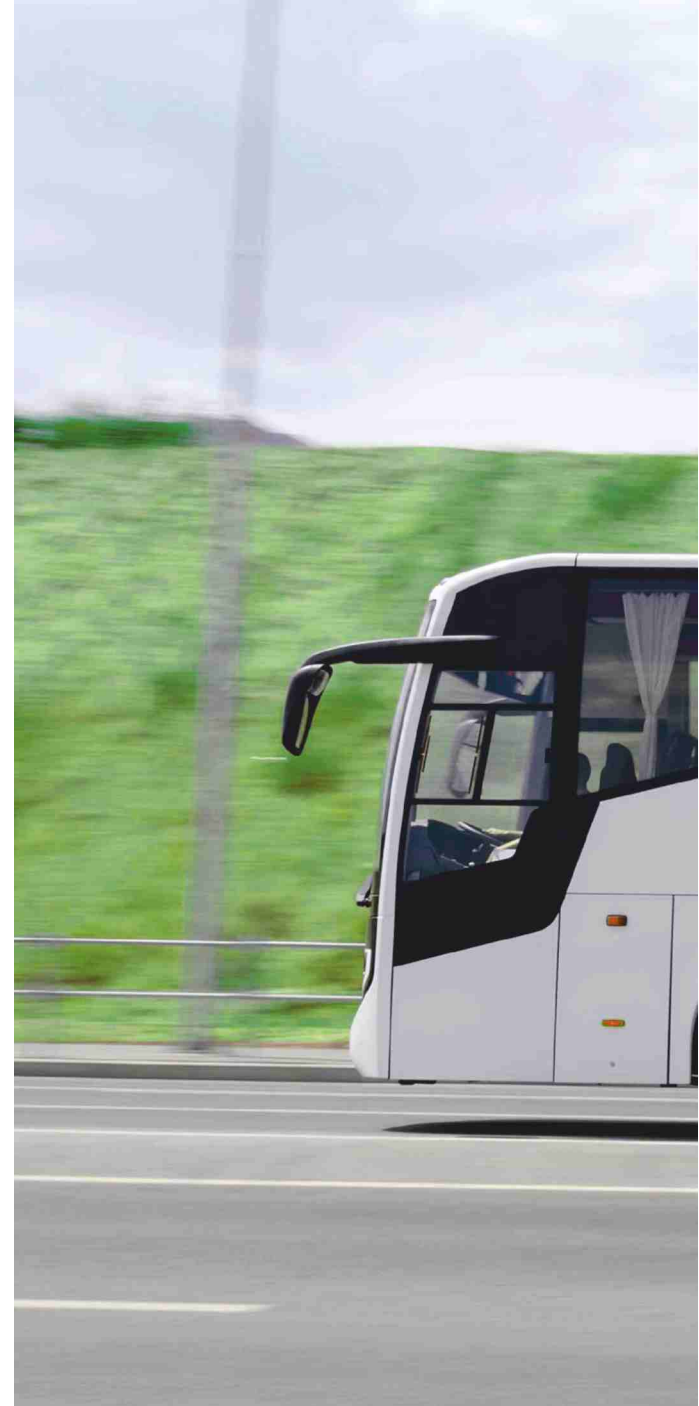







DELTA

EURO-5

**Coach for intercity
and international routes**

Modifications

Factory id	VOLGABUS 528505-0000010	VOLGABUS 528507-0000010
Engine	MAN D2066LOH37 EURO 5	CUMMINS ISL 360 EURO 5
Output, kWt	235	264
Gear box	Automatic	Automatic

Interior layout
[BASIC]

45

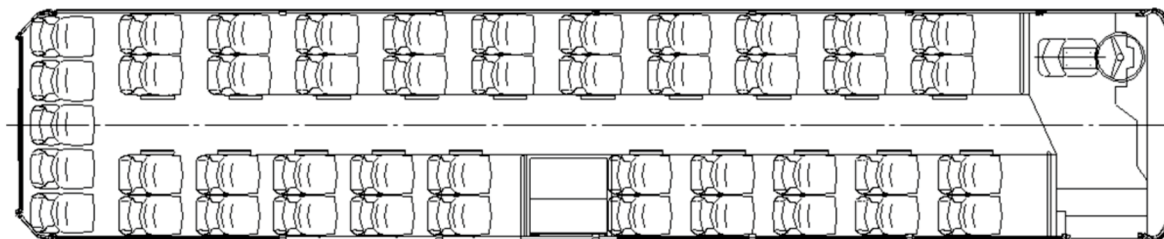

Specifications

Body	One-story, closed, all-metal, monocoque, carriage layout
Wheel base	4 x 2
Dimensions, mm	L 12800 x W 2550 x H 3330 H 3520 with AC (optional)
Unladen weight, kg	13 080
Total weight, kg	18 000
Front axle	ZF
Drive axle	ZF
Front suspension	Dependent, pneumatic. 2 hydraulic telescopic shock absorbers, 1 body position adjuster, anti-roll bar. Optional. pneumatic with control system (ECAS)

Back Suspension	Dependent, pneumatic. 4 hydraulic telescopic shock absorbers, 2 body position adjusters. Optional. pneumatic with control system (ECAS)
Steering	Hydraulic
Brake system	With electronic control (EBS)
Climate system	Diesel liquid heater, optional air conditioning
Tyres	Tubeless 295/80 R22, 5

Contacts

Sales department

info@bakulingroup.ru

+7 (495) 109 04 20

volgabus.ru

